

# MODEL 3133

Movement POLJOT Russia.

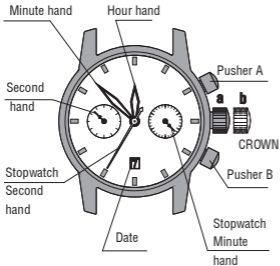

Notes: Crown has 2 positions:

- a – mainspring winding;
- b – time/date setting.

Pusher A – start and stop of the stopwatch;

Pusher B – reset of the stopwatch.

**WARNING:** never press pusher B (chronograph reset), while chronograph is running (big stopwatch seconds hand is moving). Always press pusher A first in order to stop the chronograph.

# MODEL 3133

## TO UNSCREW THE CROWN:

1. Turn it counterclockwise until tight.
2. Then you can wind the main-spring or pull crown out for time/calendar setting (Pos. "b")

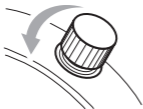

## TO SCREW IN THE CROWN:

1. Return the crown in Pos. "a".
2. Turn crown clockwise while pressing it lightly until tight.

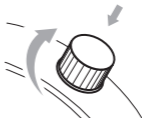

## **WATCH WINDING**

Turning the crown clockwise in the Pos. “a” wind up to the stop the mainspring of the watch.

- It can be allowed to wind the watch turning the crown counterclockwise and clockwise alternatively.
- Do not wind your watch with all your might, it can result in a break age of the winding device or the mainspring.

## **TIME/CALENDAR SETTING**

1. Pull the crown in Pos. “b”, turning it clockwise, turn hands until the desired age and (or) phase of the moon installs.  
2. Turn hands clockwise and counterclockwise alternatively in the range

12h—11h—12h by the crown until the previous day’s date appears.

3. Turning the crown clockwise, turn hands until the desired date appears. Continuing turning crown set the hands to the desired time.

Notes:

- check that AM/PM is correctly set. The watch is so designed that the date changes once in 24 hours. Turn the hands past the 12 o’clock marker to determine whether the watch is set for the A.M. or P.M. period. If the date changes, the time is set for the A.M. period. If the date does not change, the time is set for the P.M. period.
4. Return the crown in Pos. “a”.

- The stopwatch can measure up to 30 minutes in 1/3 seconds;
- The stopwatch has sweep second hand, its minute hand moves at oneminute intervals.
- After 30 minutes, it will start counting again from “0”.
- To start and to stop – press the pusher “A”.
- To reset – press the pusher “B”.

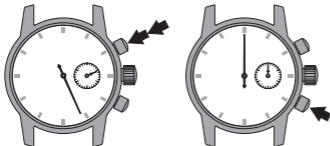
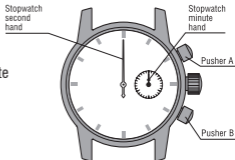

### Standard measurement

**A > A > B**

Start Stop Reset

### Accumulated elapsed time measurement

**A > A > A > ..... > A > B**

Start Stop Restart Stop Reset